

The SonicWall Mobile Connect application works in combination with SonicWall Secure Mobile Access (SMA) or next-generation firewall appliances. **The encrypted SSL VPN connection will protect traffic from being intercepted and keep in-flight data secure.** Context-aware authentication ensures only authorized users and trusted devices are granted access.

The fundamental process of using the SonicWall Mobile Connect Application is the same across all kinds of devices, however the Application has to be downloaded and configured from each of the devices respective Application Stores which we link to below.

The setup and usage process, which is explained in much more detail later in this guide is to;

1. Download and install the SonicWall Mobile Connect Application
2. Configure the VPN Connection with a Name, your Server Address and your Username and Password
3. Use the VPN to connect to your work network when you are out of the office and secure your internet traffic
4. Turn off the VPN when no longer required

APPLICATION DOWNLOAD LINKS

Please download and install the app for your required platform from the links provided;

Windows 8.1 – Windows 10

<https://www.microsoft.com/en-gb/p/sonicwall-mobile-connect/9wzdncrdsfkz>

Android Smartphone/Tablet

<https://market.android.com/details?id=com.sonicwall.mobileconnect>

Apple iPhone/iPad (iOS Device)

<https://apps.apple.com/us/app/sonicwall-mobile-connect/id466931806>

Apple MacOS

<https://apps.apple.com/us/app/sonicwall-mobile-connect/id822514576>

Amazon Fire Tablet

<https://www.amazon.com/SonicWALL-LLC-Mobile-Connect/dp/B00H2THAUK>

Google ChromeBook (Chrome OS)

<https://chrome.google.com/webstore/detail/sonicwall-mobile-connect/fcjpkgjilceclkhaoimnmkekfnehnei>

SERVER ADDRESS

When setting up SonicWall Mobile Connect on your device you will be asked for a Server Name / Address and your Username and Password. Your Username and Password will be your Network/Windows Logon Username and Password that you use to access your PC/Network when in the office unless told otherwise.

Your server address is

CONTACT CETSAT FOR SERVER ADDRESS

Please retain this as it will be needed later in this guide.

SETTING UP ON A WINDOWS DEVICE

Once you have installed the SonicWall Mobile Connect App from the Microsoft Store it will appear in your “Recently Installed” Applications in the Start Menu.

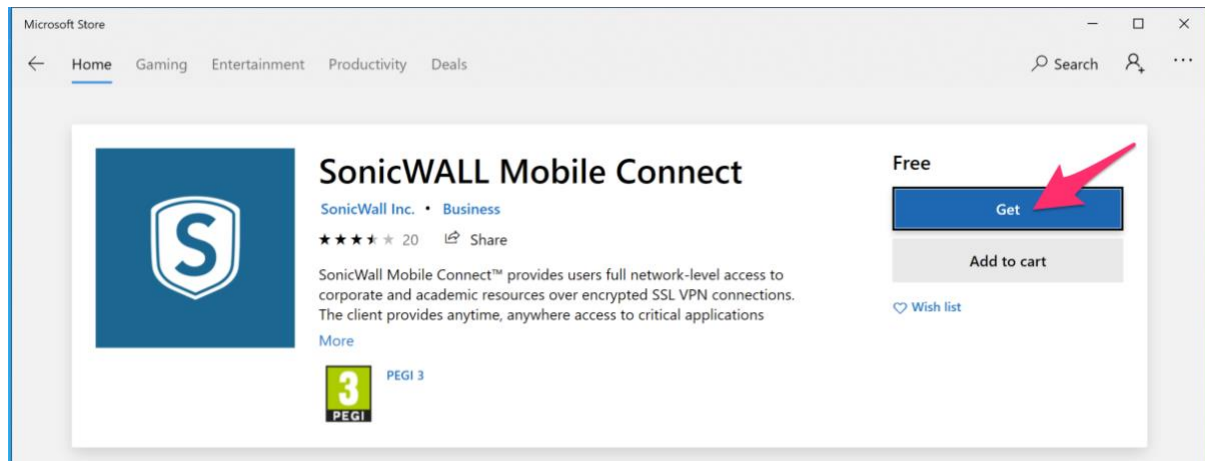

The SonicWall Application is not used like regular apps though and requires the VPN to be configured though the Settings Application within Windows instead.

1. Launch the Settings app

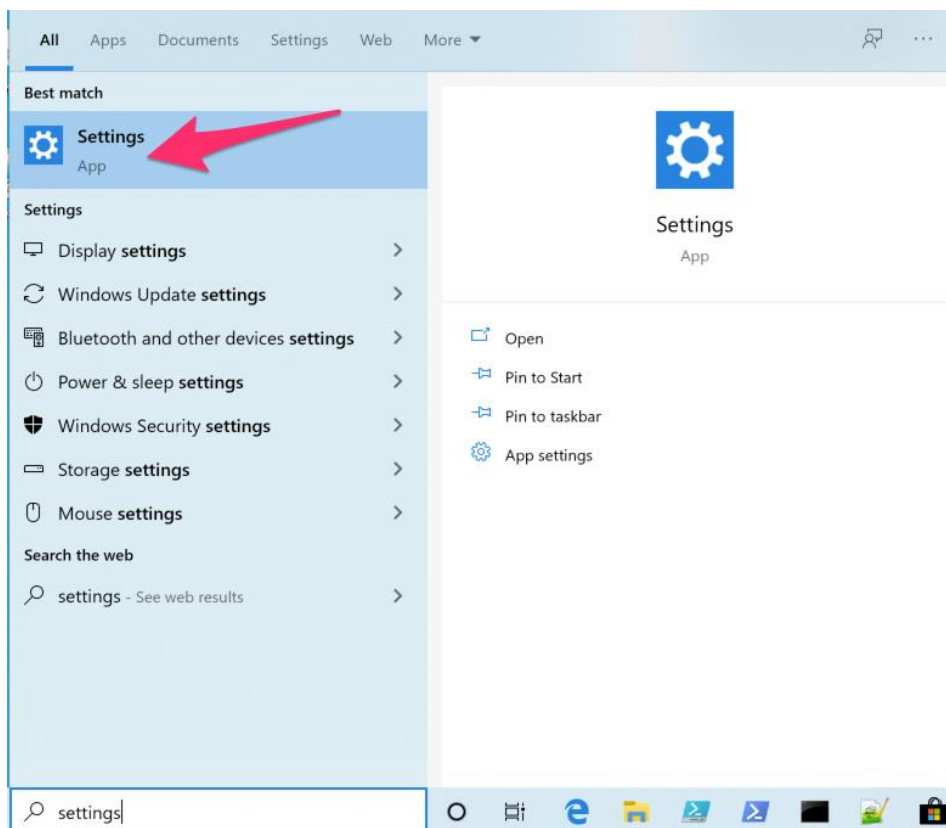

2. Navigate to **Network & Internet > VPN**.

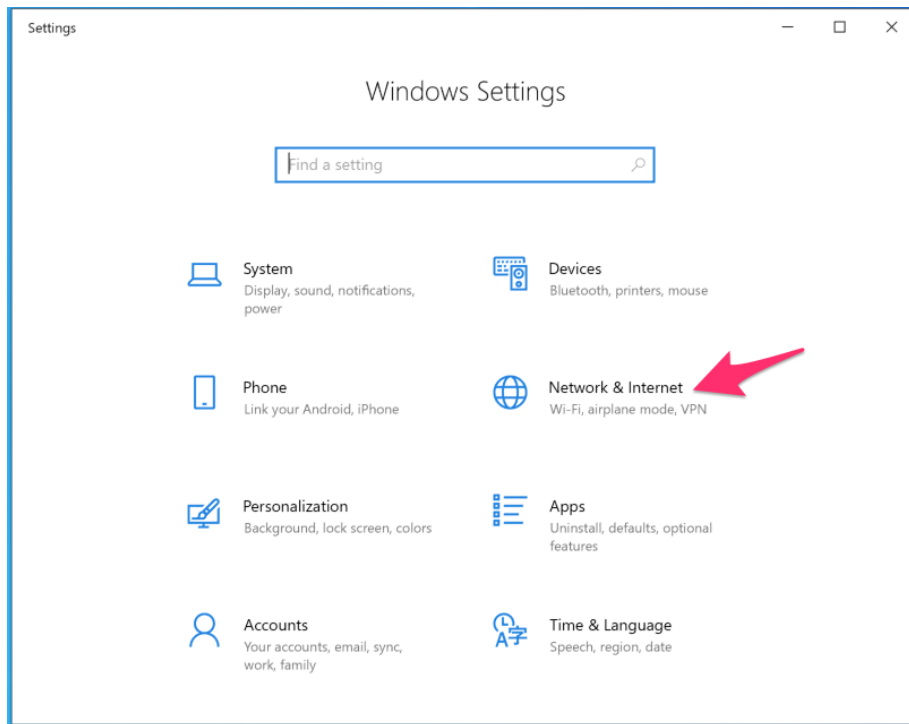

3. Under VPN, select **Add a VPN** connection.

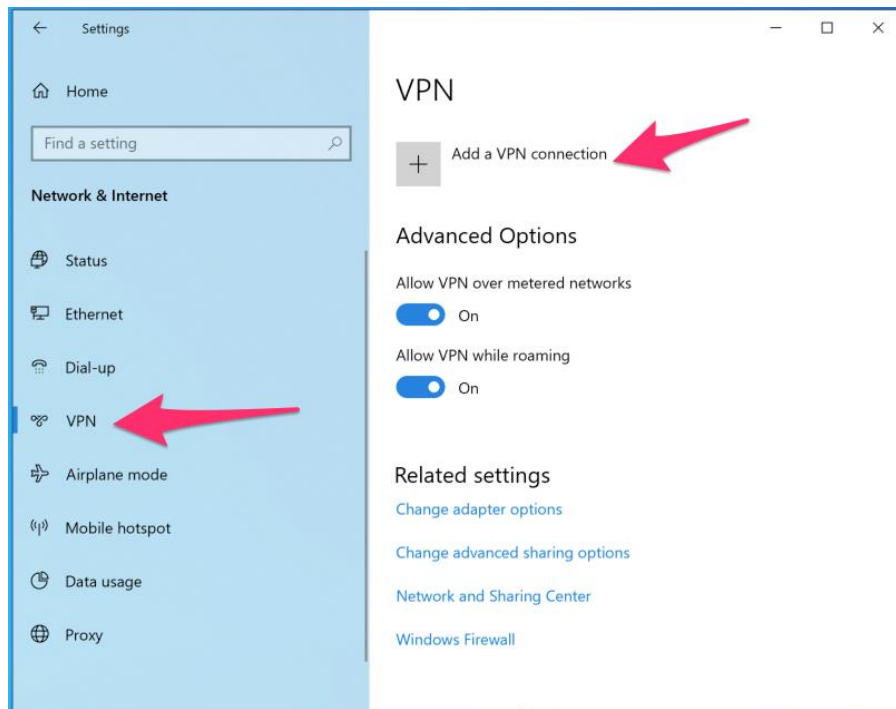

4. Select SonicWall Mobile Connect as your provider, give the connection a name you will remember and then enter the **server address** from page 1 of this document and then press Save.

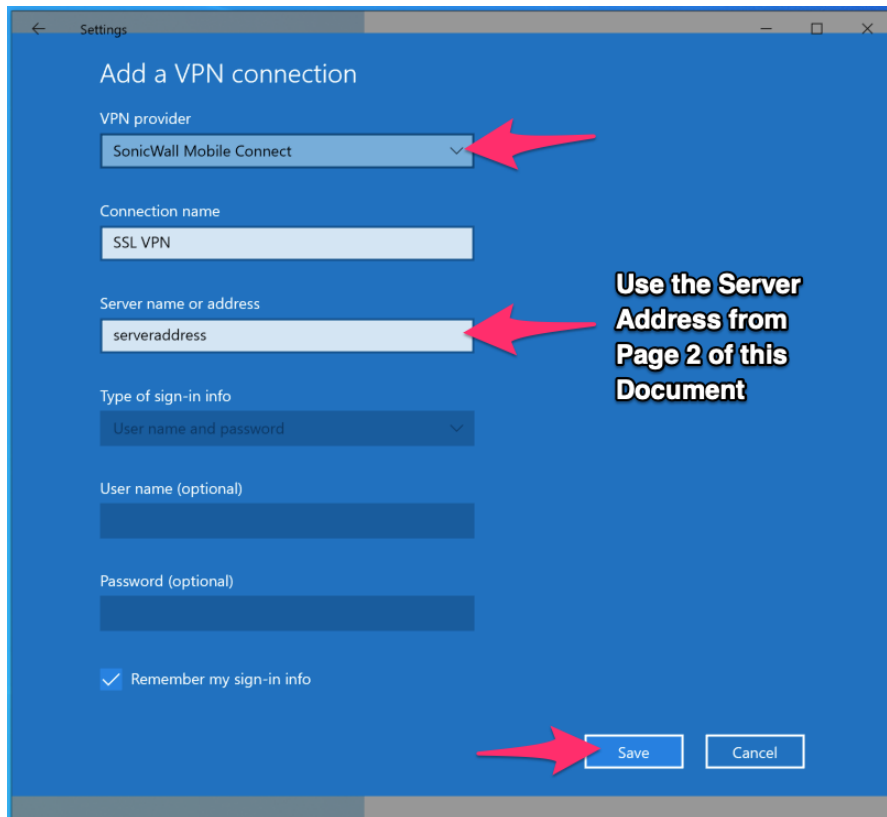

5. Once you have saved the configuration it will show as an available VPN which you can click to connect to in the settings app. You can jump straight to this connection window by using the Windows Notification Centre (down at the bottom of the right of your screen near your time/date)

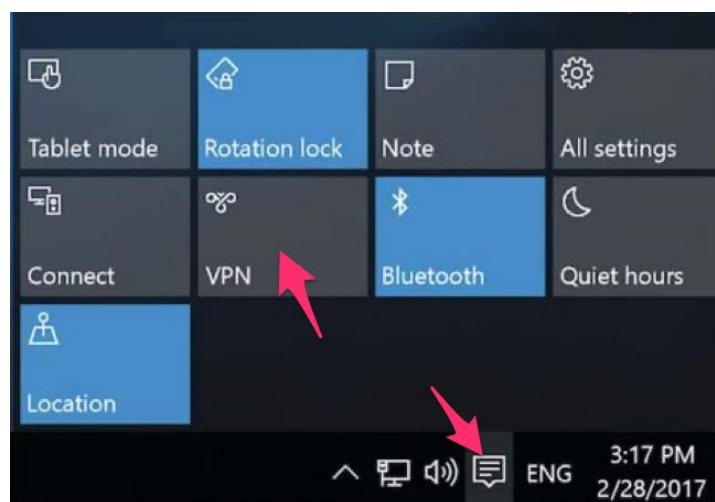

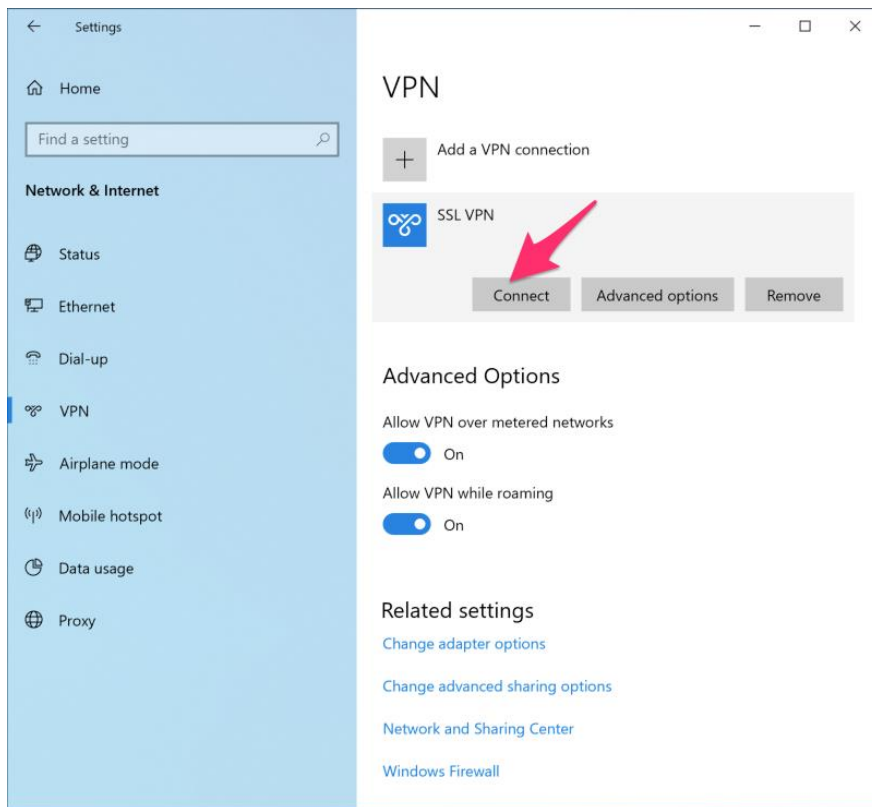

When you connect it will ask for your Username and Password to complete the connection and once connected you will be connected to your works internal network. Unless told otherwise this will be the Network Username and Password you use to logon when in the office.

When the connection is successfully established, the **Status** changes to **Connected** and the **Disconnect** button replaces the **Connect** button.

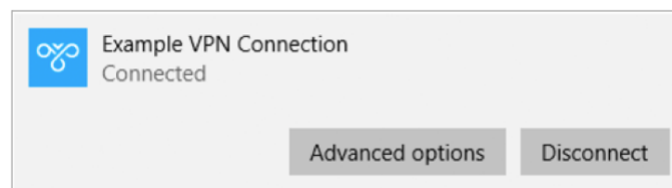

Once connected, you can access the remote network. The Networks screen shows the status of the VPN connection.

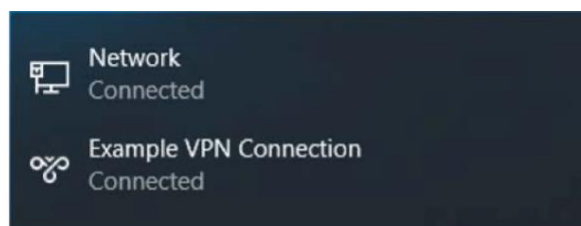

If the VPN connection is interrupted, the VPN icon shows as disconnected and you will no longer be able to access the remote network. Return to the Networks screen to re-establish the VPN connection. Windows 10 will automatically attempt to re-establish interrupted connections.

SETTING UP ON A SMART PHONE OR TABLET

Please download the SonicWall Mobile Connect App from your respective App Store (i.e. Google Play, App Store or Amazon Store) using the links on the first page of this guide.

Once downloaded the app is near identical, with parity across all iOS (Apple), Android and Amazon Fire Devices. Please open the SonicWall app from your home screen and then tap

1. Add Connection
2. Create a new connection
3. Give the connection a name you will remember and then enter the **server address** from page 1 of this document and then tap Next
4. When you tap next, if the address is correct it will then ask for your Username and Password, unless told otherwise this will be the Network Username and Password you use to logon when in the office. The Domain field should have auto-populated.
5. Tap Save once you have added all fields
6. If your device asks for permissions to add a configuration at this point, please press allow.

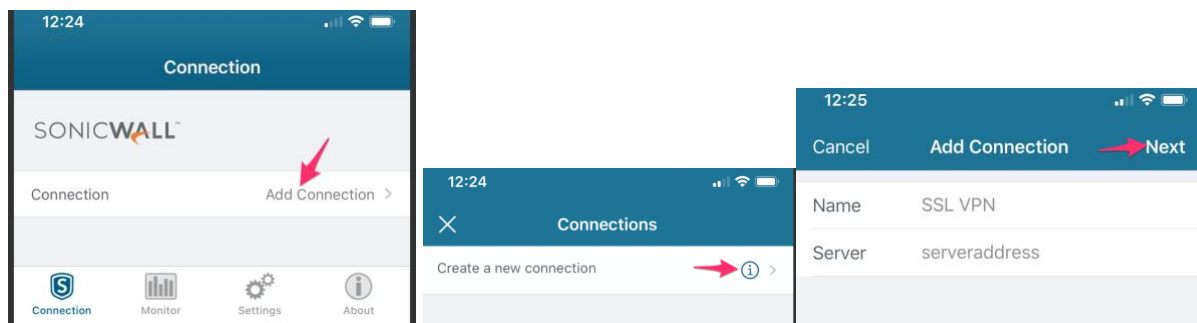

Once this has been added to your device, simply turn the VPN on and off from within the app. Once connected, you can access the remote network.



When connected from within the app you can use the monitor to look at connection settings and details. You can also turn on the Auto Reconnect in the Settings part of the app, this should be on by default though.

SETTING UP ON AN APPLE MacOS DESKTOP/LAPTOP

Please download the SonicWall Mobile Connect App the Mac App Store using the link provided on the first page of this document. Once downloaded the Application will appear in the Applications Folder on your Mac.

Please open the app and follow these steps;

1. Add Connection
2. Give the connection a name you will remember and then enter the **server address** from page 1 of this document and then tap Next
3. When you tap next, if the address is correct it will then ask for your Username and Password, unless told otherwise this will be the Network Username and Password you use to logon when in the office. The Domain field should have auto-populated.
4. Tap Save once you have added all fields
5. If your device asks for permissions to add a configuration at this point, please press allow.

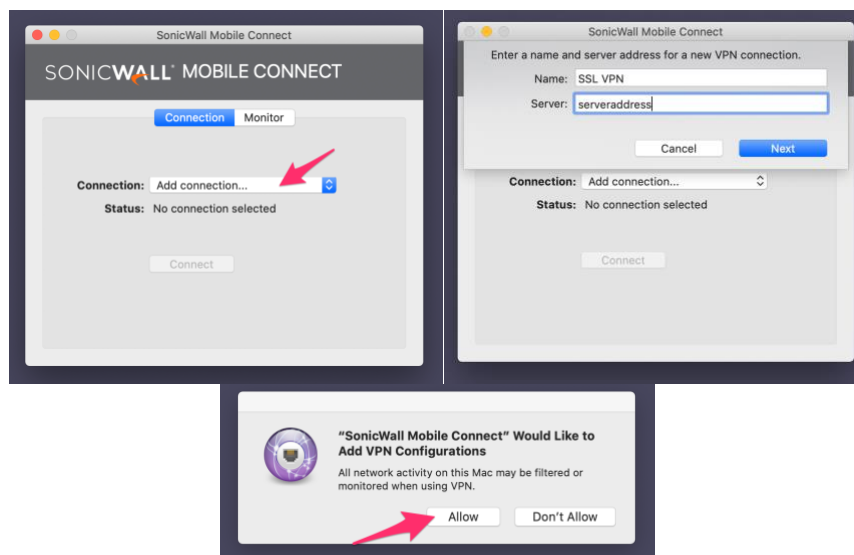

Once this has been added to your device, simply turn the VPN on and off from within the app. Once connected, you can access the remote network. You can also see a SonicWall Shield in the Menu Bar at the top of your Mac's Screen where you can click to Connect and Disconnect when the app is open

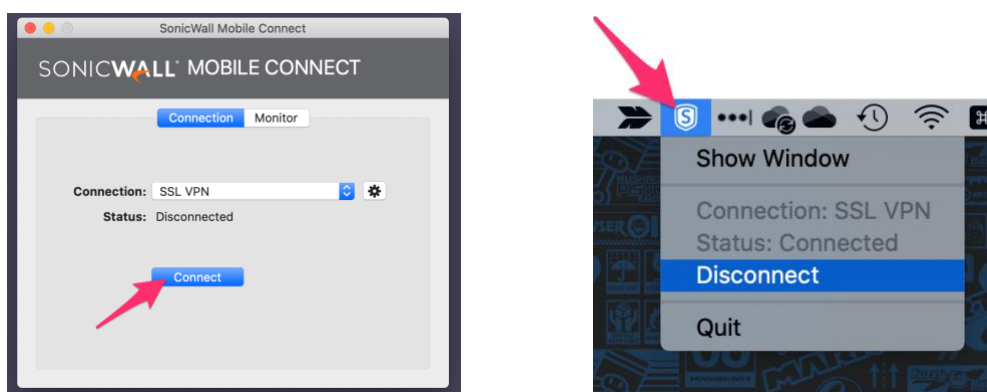

When connected from within the app you can use the monitor button to look at connection settings and details. The VPN will also automatically attempt to re-establish interrupted connections.